



TOPIC: Social Studies
Geography
GRADE LEVEL: 4 - 6
TIME: Adaptable

GEOGRAPHY ACTIVITIES

OBJECTIVE: The student will extend their knowledge of geography vocabulary by completing any of four separate activities.

MATERIALS NEEDED:

1. The *Geography Vocabulary List* for each student would be helpful but not mandatory in completing any of the four activities.
2. The four activities require *Student Activity Sheets*, but some could be made by the students as opposed to making copies.
3. *Student Data Sheets* for each student.

PROCEDURE:

1. Instruct the students to follow the instructions printed on the activity sheets that you give them to complete.
2. Correct the activity sheets in class.
3. Collect the activity sheets for teacher evaluation. Be sure that each is properly identified.

THE GLOBE GNOME'S GLOBALIZING GAME



1. As quickly as you can, list all the descriptive words found in each globe.
2. Think of as many unique words as possible. Remember, all your ideas are accepted.

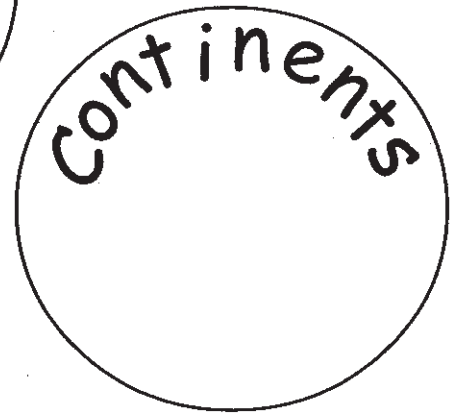
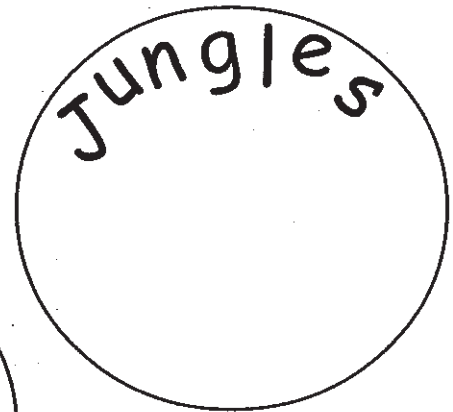
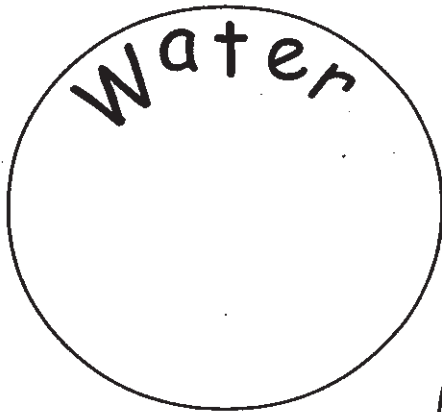

3. Now give yourself a bit more time, read over your word groups and see if you can add to the list or change any of your words.
4. Share your words with other students.
5. Select one category of words and use as many as you can in a poem or short descriptive story. Write it on the back of this paper.

STUDENT ACTIVITY SHEET

Activity 1

WORD SEARCH

Find the geographical terms. They read horizontally, vertically, and diagonally. None read backward.

- boundary
- degree
- vegetation
- precipitation
- political
- scale
- symbols
- latitude
- climate
- longitude
- elevation
- continent

```

rgw pkuomghognfiemldgjtckmtsnr
admuprglygiboundaryckalzaedlg
vegetationjlfpoliticalctbasc
ngwtzsbmknogvmtcufljbyannngfo
orvavstukhzkljskpeieeamdfigdi
wecgsyysrgppaweldrgdmihdefauk
beb xrmz wgonmtnoreceilhgbdkbpb
ycdeg bagtpijiuvwfjhcxcolpgvi
agcfcontinentglmkhkiimvurawh
ztvo yldisrlturpbnjghnpwpjtcgx
dgxegscaleesdgdkofodxiyzscey
afuw yxwvutvhekdi hvewgxjtcbazc
erazcndempaf ljkzydbxvwayazefb
bsfbc pognithmlumdulnknjuotbga
sqre jtlongitud ecvmcrqwpoxiyifp
shkgf thiluoruvbswadxcybzxlzof
feij mlpfbhnemclikjtzvyxathann
    
```

Activity 2

WORD LINK

CONVERGENT

WORD LINK Link all the geographical terms. Every word must be a part of another - no word may be written backward.

Example:

```

continent
l d
latitude
o m g
n a r p
g t e r
i e elevation
t c
u i
d p
e i
t a
t i
boundary
n
    
```



Activity 3

WORD SHAPES - Match the geographical terms to the word shapes.

boundary



degree



vegetation

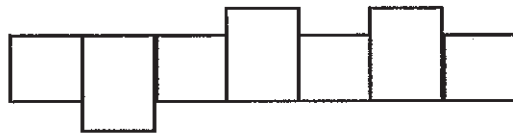

precipitation

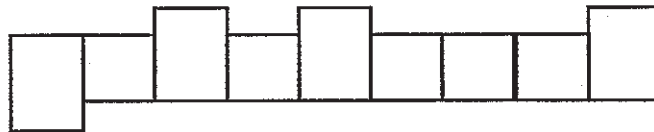

scale

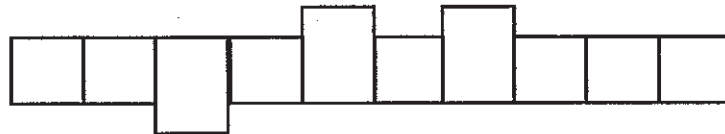

symbols

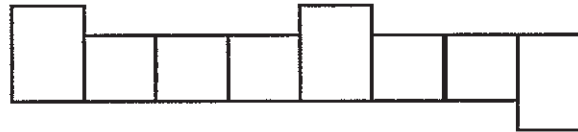

latitude



climate

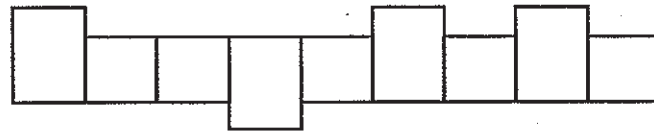

longitude



elevation



continent



political

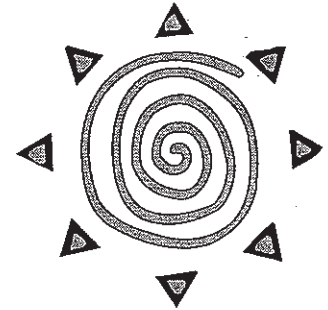

GEOGRAPHY VOCABULARY LIST

Bar Graph

A graph in which different quantities are represented by rectangles of different lengths.

| CLASSES | 5 | 10 | 15 | 20 | 25 | 30 | 35 | 40 |
|------------|---|----|----|----|----|----|----|----|
| Muir's | | | | | | | | |
| Hinckle's | | | | | | | | |
| Eyestone's | | | | | | | | |

Boundary

A line separating one piece of land from another (towns, cities, states, nations all have boundaries).

Chart

A sheet showing information in the form of lists, diagrams, tables, graphs, or the like.

Coordinates

One of a set of numbers that give the position of a point in a line, in a plane, or in three dimensional space.

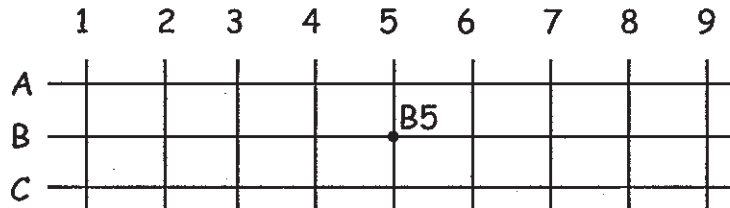

Data

Information from which conclusions can be drawn; facts and figures.

Degree

Unit of measurement of distance around the world which is approximately 67 miles (represented by a °, i.e. 58°).

Diagonal

Having a slanting direction.

Diagram

A figure, plan, sketch or set of lines giving the outline or general scheme of something to show how it is put together or how it works, or to show the course or result of an action.

East

One of the four main points on a compass which is on the right side of a map; direction a person faces when he watches the sun rise.

Equator

0° latitude.

Elevation

Height above the earth's surface or above the sea level shown on a contour map.

Feet

A distance measurement of twelve inches.

Graph

A diagram showing the changes of and the relationship between two or more things by a series of dots, bars, lines, or pictures.

GEOGRAPHY VOCABULARY LIST

Grid

A pattern of intersecting parallel lines used to divide a map or chart into small squares.



Horizontal

Parallel to the horizon.

Key

A key of a map or chart supplies information to help you read that map or chart.

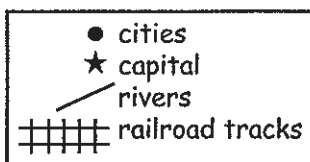

Latitude

Imaginary lines that divide the earth into units of measurement. Latitude lines run east to west and measure distance north and south of the equator.

Line Graph

A graph in which different quantities are represented by lines connecting specific coordinates.

Location

Exact position; place.

Longitude

Imaginary lines that divide the earth into units of measurement. Longitude lines run north and south and measure distance east and west of the prime meridian.

Map

A drawing or other representation of all or part of the earth's surface, usually showing cities, rivers, oceans, mountains, and other features.

Measurement

To find the dimensions, weight, extent, quantity or capacity of.

Mile

A unit of linear measure equal to 5,280 feet.

Minute

A unit of angular measurement equal to 1/60 of a degree (represented by a ', i.e. 58° 17').

North

One of the four main points on a compass. It is towards the top of a map.

Observation

The act or practice of examining, noting, and recording the top of a map.



Parallel

A set of lines going in the same direction and always being the same distance apart at every point so as never to meet.

GEOGRAPHY VOCABULARY LIST

Pictograph

A graph in which different quantities are represented by pictures.

| | |
|---|---|
| KEY  = 10 STUDENTS | |
| MUIR'S |  |
| HINCKLE'S |  |

Prime Meridian 0° longitude

Scale The proportion that a plan, map or model has to what it represents.

Scale of Miles The clue to the proportion that a plan, map or model represents (i.e. 1" = 200 miles).



Schedule A written or printed table or list as of rates or prices.

South One of the four main points on a compass. It is towards the bottom on the map.

Symbol Something that stands for or represents something.

Table An orderly arrangement of facts or information usually in a list.

Title The name by which a particular thing is identified.

Vertical At a right angle to the plane of the horizon.

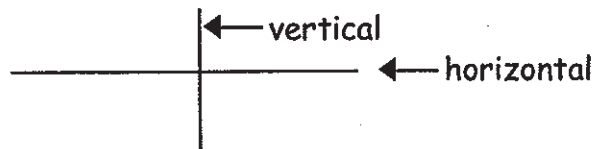

West One of the four main point on a compass. It is on the left of a map.

TEACHER ANSWER KEY

Activity 1

WORD SEARCH

Find the geographical terms. They read horizontally, vertically, and diagonally. None read backward.

- boundary
- degree
- vegetation
- precipitation
- political
- scale
- symbols
- latitude
- climate
- longitude
- elevation
- continent

```

rgwpkuomghognfiemldgjtckmtsnr
admuprglygiboundaryckalzaedlg
vegetationjllhfpoliticalctbasc
ngwtzsbmknogvmtcuflijbyanngfo
orvavstukhzkljkskpeieeamdfgdi
wecgsysrgppaweldrgdmihdefauk
bebxrmzwwgonmtnoreceilhgbdkbpb
ycdegbagtpijiuvwfjhcixcolpgvi
agcfcontinentglmkhkiimvurawh
ztvoyldisrlturpbnjghnpwpjtcgx
dgxegscaleesdgdkofodxiyzscey
afuwyxwvutvhekdihvewgxjtcbazc
erazcndempafljkzydbxvwayazefb
bsfbcpognithmlumdulnknjuotbga
sqrejtlongitudecvmcrqwpoxiyfp
shkgfthiluoruvbswadxcybzxlzof
feijmlpfbhnemclikjtzvyxathann
    
```

Activity 2

WORD LINK

CONVERGENT

WORD LINK Link all the geographical terms. Every word must be a part of another - no word may be written backward.

Example:

```

continent
l d
latitude
o m g
n a r p
g t e r
i e elevation
t c
u i
d p
e i
t a
t i
boundary
n
    
```



Activity 3

WORD SHAPES - Match the geographical terms to the word shapes.

boundary

e l e v a t i o n

degree

c l i m a t e

vegetation

s y m b o l s

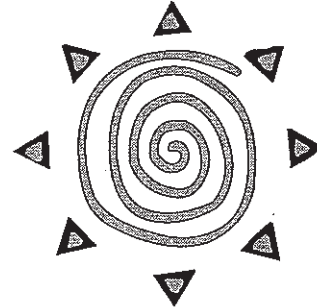

precipitation

p o l i t i c a l

scale

v e g e t a t i o n

symbols

b o u n d a r y

latitude

c o n t i n e n t

climate

l o n g i t u d e

longitude

l a t i t u d e

elevation

s c a l e

continent

p r e c i p i t a t i o n

political

d e g r e e

